

FS TRACK INSTALL INSTRUCTIONS

BY SIMPLY FOLLOWING THESE STEP-BY-STEP INSTRUCTIONS, YOU WILL SOON BE ENJOYING YOUR NEW DRAPERY HARDWARE.

Getting Started:

Please read through all instructions carefully before you begin.

Unpack all materials making sure all components are included:

- Track(s)
- Master carrier(s) & carriers (pre-installed within track)
- Mounting brackets
- Splice, if requested

Tools You Will Need:

- Drill with a 1/8" bit and a Phillips bit
- Phillips screwdriver
- Metal tape measure
- Hack saw (optional)

Wall Mount Instructions:

Installing Your Drapery Track:

You are now ready to install your Forest Drapery Track System.

1. Measure

Determine the height of the top of track and mark bracket height on the wall for all the brackets and adjust (as necessary) to make sure they are all leveled.

2. Mark

Measure the width of the track and mark the two end brackets approximately 3" - 4" in from the ends of the track. Evenly space the remaining brackets and place corresponding marks.

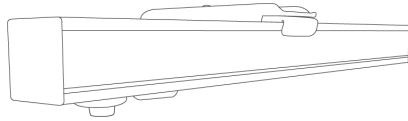

3. Mount

To attach the bracket to the wall; first pre-drill holes for screw diameter when mounting into wood frame of window or wall stud. Otherwise, pre-drill and install anchors first before fastening with screws.

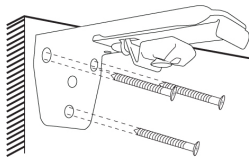

4. Attach Bracket

Place the track into the bracket as shown in the drawing; applying pressure until track "clicks" into bracket. Make sure track set screw is loose enough to allow the track retainer to flex. Repeat this step for the remaining brackets.

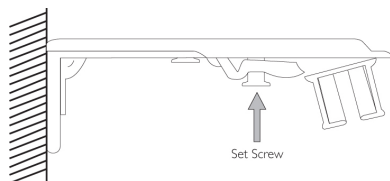

5. Tighten

Tighten track set screws on all the brackets to secure track to brackets.

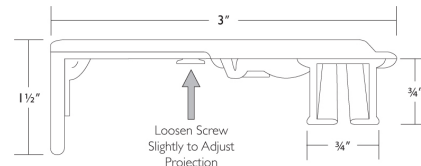

6. Adjust Projection

Adjust track to the desired projection. Projection is adjustable from 3" - 4 1/2". Repeat this step for the remaining brackets.

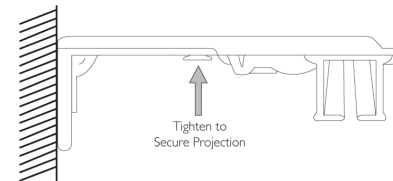

Once desired projection is set for all the brackets, lock the bracket into position by tightening the track depth adjustment set screw (see drawing below).

Installing Splice, if requested:

For wide areas, tracks will be shipped in multiple pieces and will require a splice.

- Slide the track of the connecting ends on each track into the channel of the splice and butt ends together.
- Tighten locking screw with hex key for a secure fit.

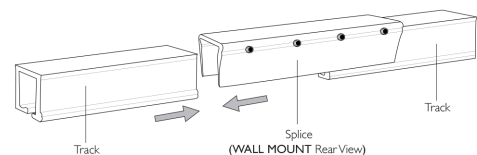

FS TRACK INSTALL INSTRUCTIONS (CONTINUED)

BY SIMPLY FOLLOWING THESE STEP-BY-STEP INSTRUCTIONS, YOU WILL SOON BE ENJOYING YOUR NEW DRAPERY HARDWARE.

Ceiling Mount Instructions:

Installing Your Drapery Track:

You are now ready to install your Forest Drapery Track System.

1. Measure

Measure the width of the track and mark the two end brackets approximately 3" - 4" in from the ends of the track. Evenly space the remaining brackets and place corresponding marks.

2. Mount

To attach the bracket to the ceiling; first pre-drill holes for screw diameter when mounting into wood frame of window or wall stud. Otherwise, pre-drill and install anchors first before fastening with screws.

3. Attach Bracket

Place the track into the bracket as shown in the drawing; applying pressure until track "clicks" into bracket. Make sure track set screw is loose enough to allow the track retainer to flex. Repeat this step for the remaining brackets.

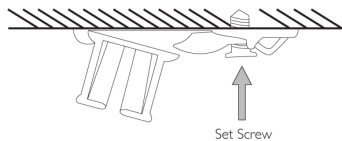

4. Tighten

Tighten track set screws on all the brackets to secure track to brackets.

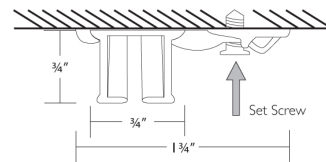

Installing Splice, if requested:

For wide areas, tracks will be shipped in multiple pieces and will require a splice.

- Slide the track of the connecting ends on each track into the channel of the splice and butt ends together.
- The tracks will snap together. Press together and confirm a tight fit.
- Secure with additional screw.

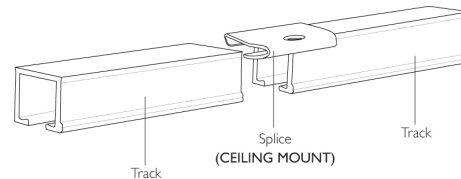

FOREST SHUTTLE INSTALL INSTRUCTIONS

BY SIMPLY FOLLOWING THESE STEP-BY-STEP INSTRUCTIONS, YOU WILL SOON BE ENJOYING YOUR NEW DRAPERY HARDWARE.

1

Assemble the track.

2

Install the brackets and insert the track to the brackets.

3

Do not attach the drapery yet. Attach the drapery after the end positions have been set. Slide the master carrier(s) into a half open position.

4

Attach the motor to the track.

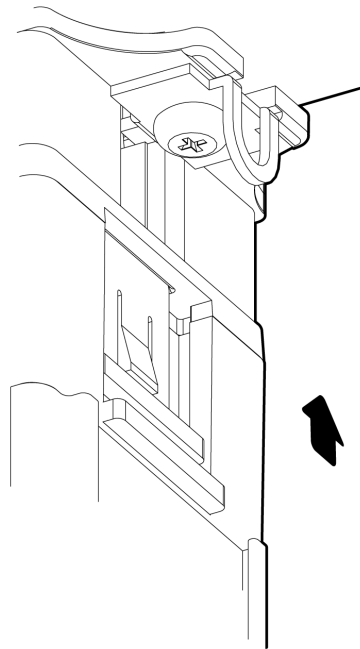

make sure to secure the locking pin in the Forest Shuttle

5

Connect the AC plug from the 24V power adaptor to the wall socket and the power plug into the motor socket. The green LED will light up. Push the configuration button, green LED will go off. Make sure strain relief is in place.

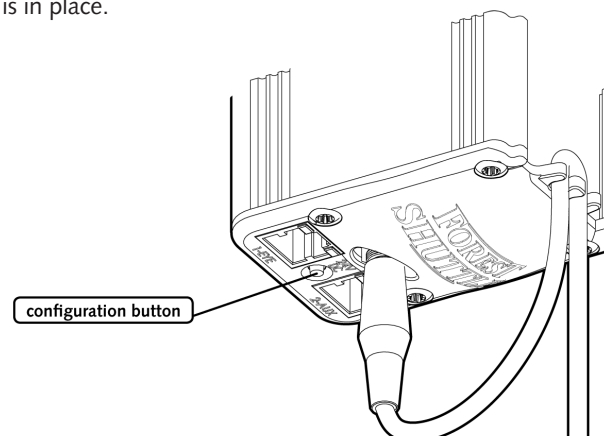

loop the power cord through the strain relief

FOREST SHUTTLE INSTALL INSTRUCTIONS

BY SIMPLY FOLLOWING THESE STEP-BY-STEP INSTRUCTIONS, YOU WILL SOON BE ENJOYING YOUR NEW DRAPERY HARDWARE.

6

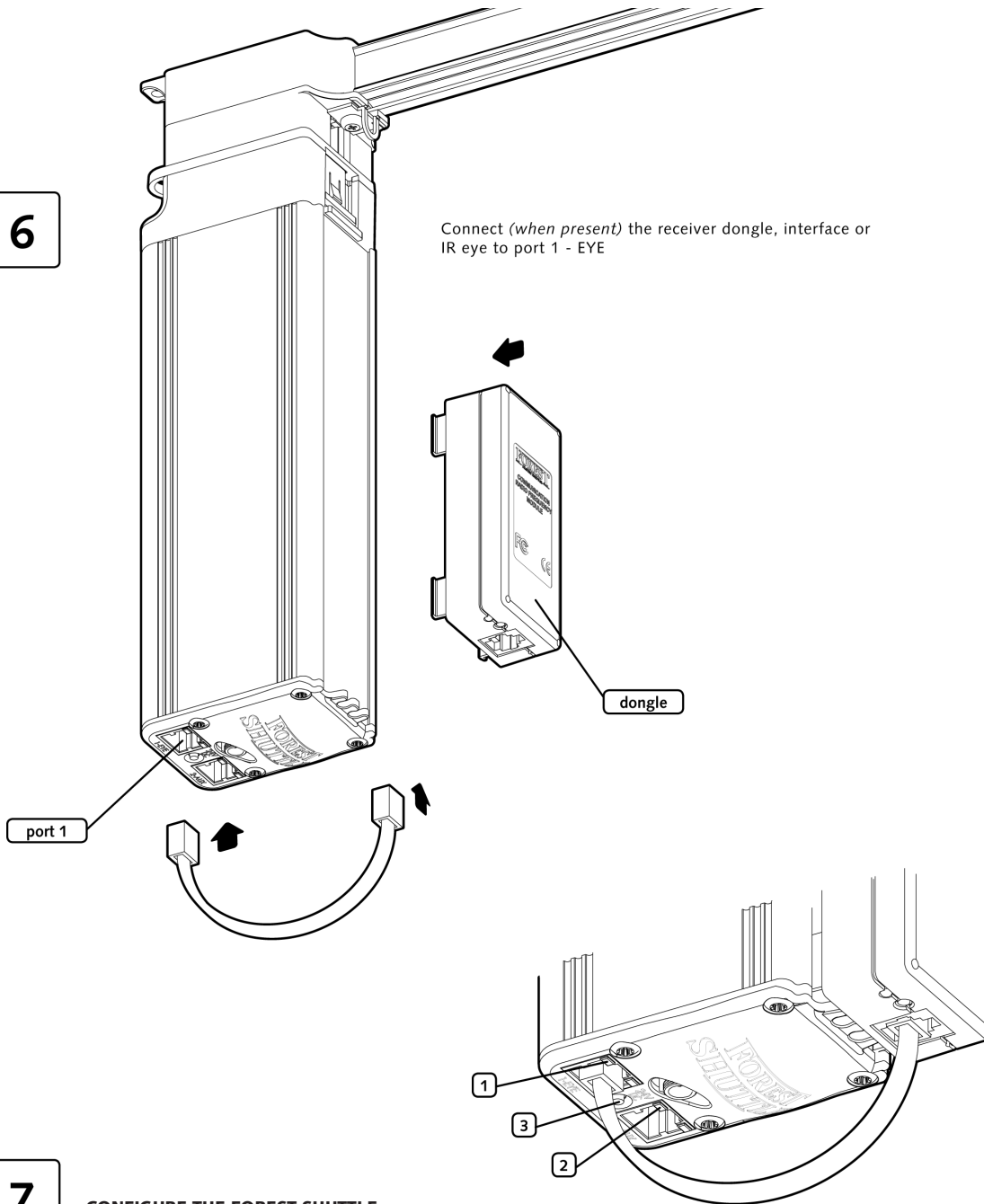

7

CONFIGURE THE FOREST SHUTTLE:

Explanation:

1. ADMIN LEDs: These are the LEDs on the left port at the bottom of the motor. Left is the green admin LED and right is the yellow admin LED. This port is marked "1 - EYE".

2. USER LEDs: These are the LEDs on the right port at the bottom of the motor. Left is the green user LED and right is the yellow user LED. This port is marked "2 - AUX".

3. CONFIGURATION BUTTON: This is the button at the bottom of the motor between the two ports. The button does not work when the motor is operating.

FOREST SHUTTLE INSTALL INSTRUCTIONS

BY SIMPLY FOLLOWING THESE STEP-BY-STEP INSTRUCTIONS, YOU WILL SOON BE ENJOYING YOUR NEW DRAPERY HARDWARE.

8a

Determining the motor direction:

Pull the master carrier to the closed position, the motor will start running towards the closed position. Pay attention to the YELLOW USER LED (at right connector).

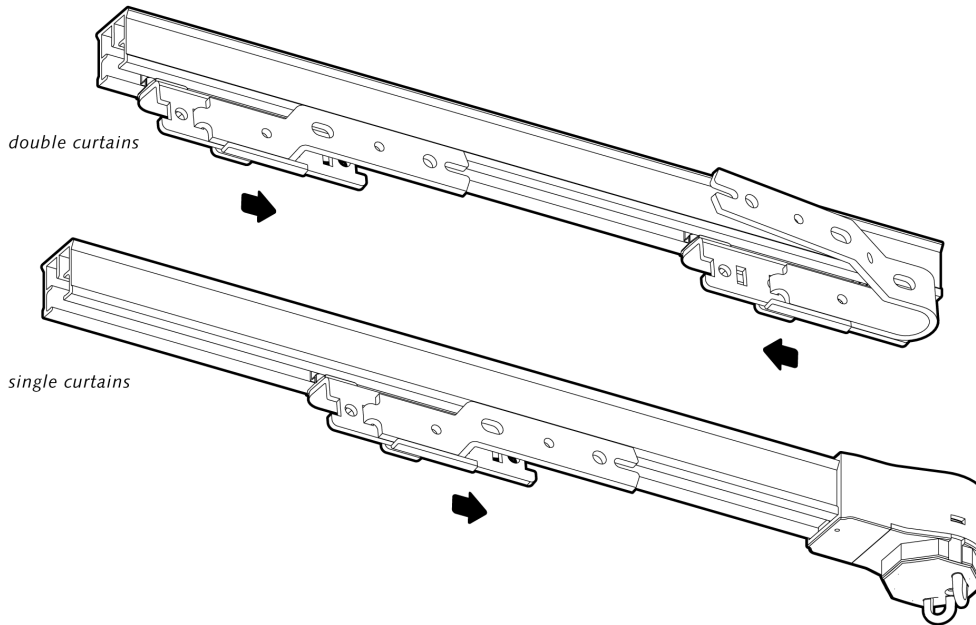

8b

Now the two possibilities are:

- a) YELLOW LED OFF, motor direction is correct, proceed to step 9.
- b) YELLOW LED ON, this indicates that the motor direction is wrong and the drapery stack back will be in the wrong position. Toggle the motor direction as shown in the options table on page 6.

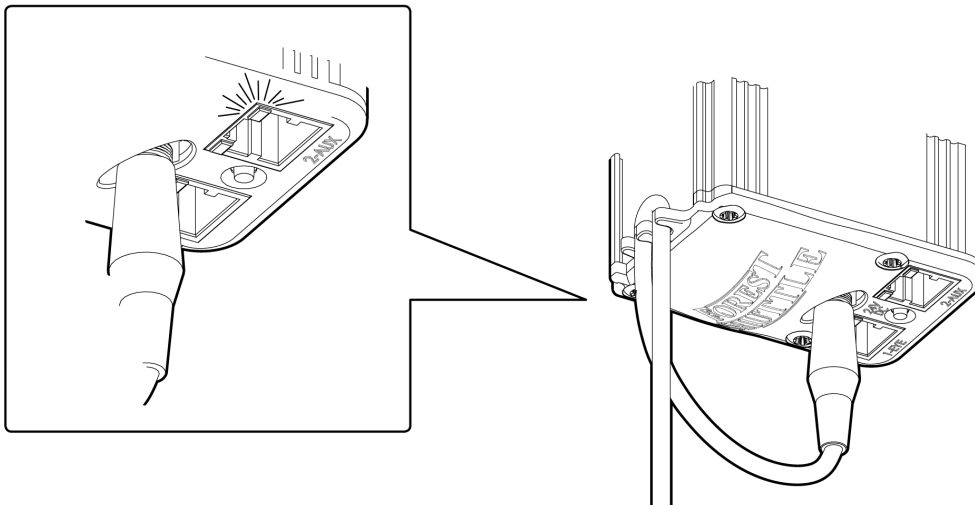

FOREST SHUTTLE INSTALL INSTRUCTIONS

BY SIMPLY FOLLOWING THESE STEP-BY-STEP INSTRUCTIONS, YOU WILL SOON BE ENJOYING YOUR NEW DRAPERY HARDWARE.

9

SETTING THE OPEN LIMITS:

Pull the master carrier in the open direction. This will start the motor and open the carriers. Once the drape has reached the OPEN position you have 7 seconds (while the YELLOW LED is on) to manually adjust the master carrier(s), setting the OPEN limit. After 7 seconds the YELLOW LED goes off and the limits are set.

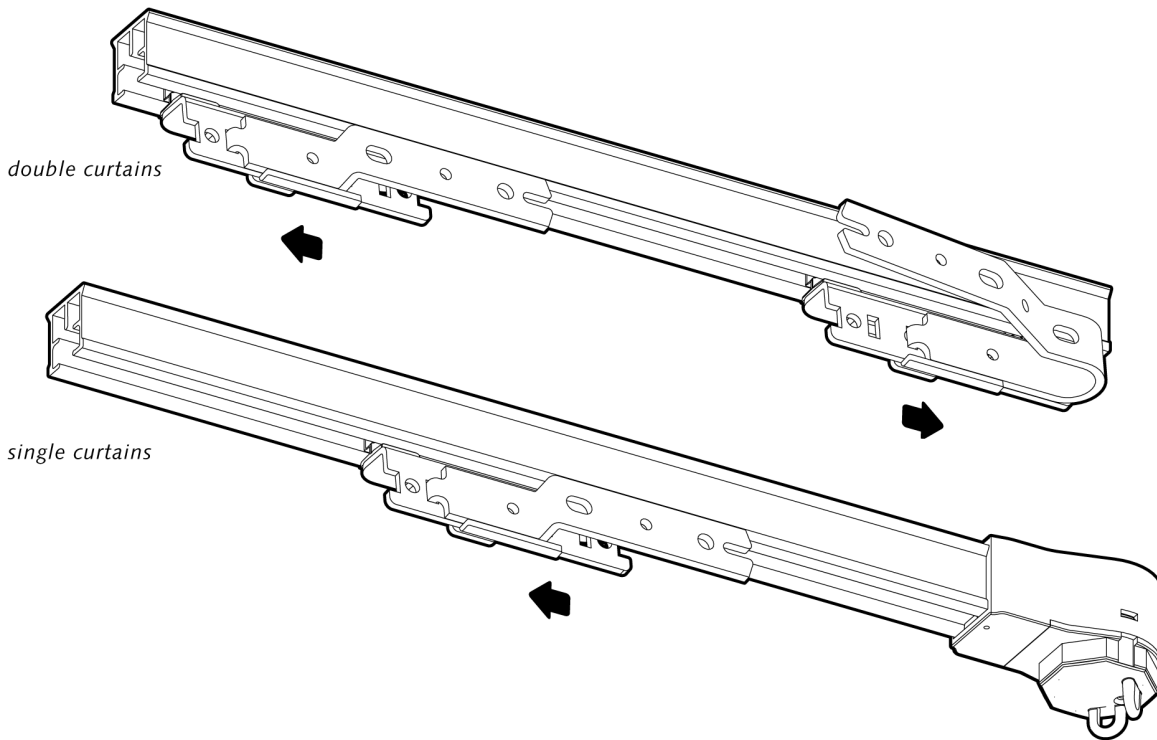

10

In case of a receiver dongle (RF or IR), always connect to port 1 - EYE.

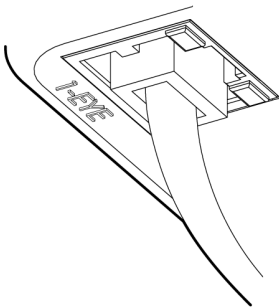

note

If you were not successful in setting the limits - re-set to factory default as shown in the options table on page 6 and proceed from step 8.

FOREST SHUTTLE INSTALL INSTRUCTIONS

BY SIMPLY FOLLOWING THESE STEP-BY-STEP INSTRUCTIONS, YOU WILL SOON BE ENJOYING YOUR NEW DRAPERY HARDWARE.

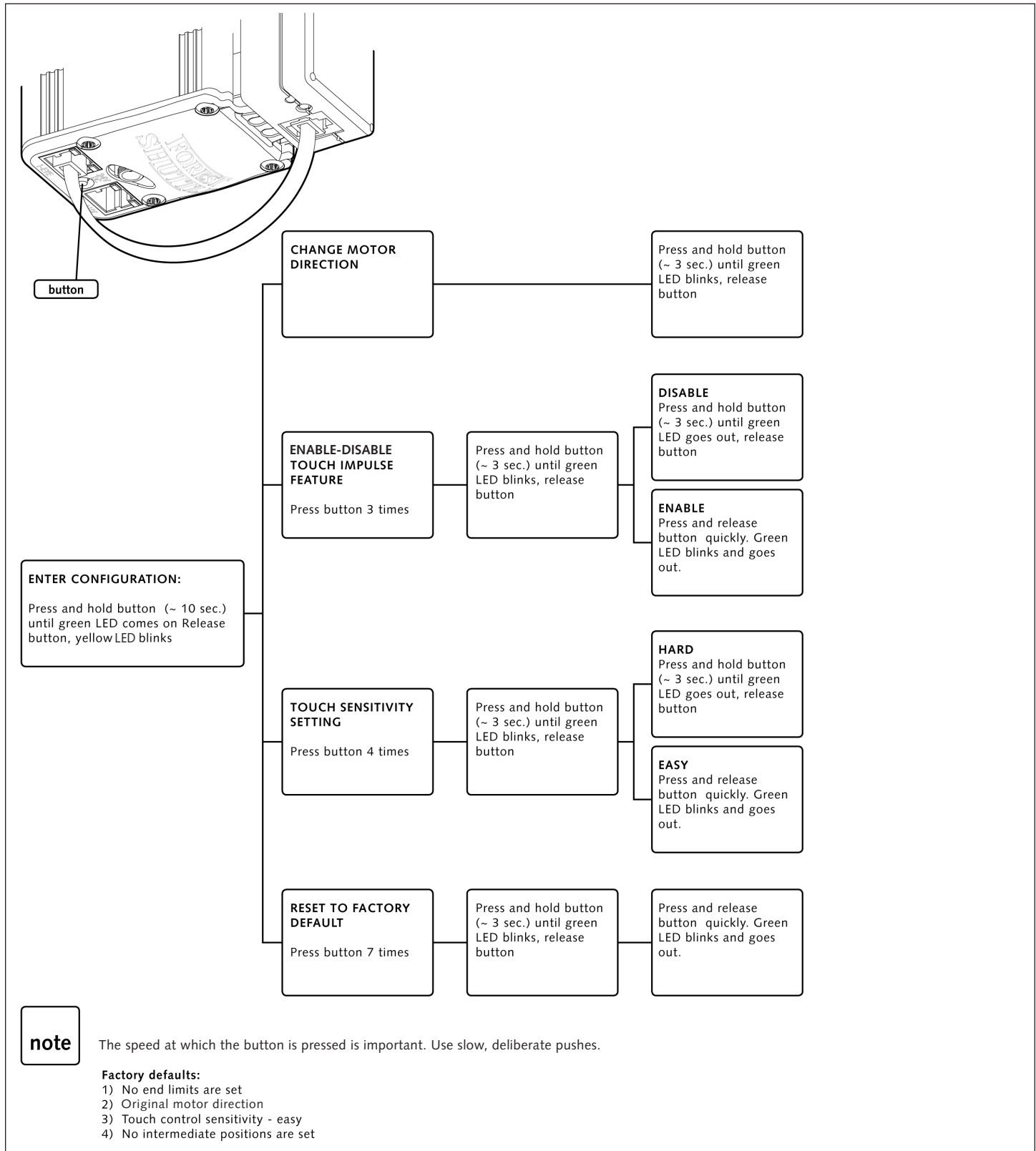

FOREST SHUTTLE INSTALL INSTRUCTIONS

BY SIMPLY FOLLOWING THESE STEP-BY-STEP INSTRUCTIONS, YOU WILL SOON BE ENJOYING YOUR NEW DRAPERY HARDWARE.

extra

CONNECTING THE WALL SWITCH

Either of the 2 ports can be used to connect a (pulse) switch to open, close or stop the drapery. Pins 1, 3 and 8 are used for this. If pins 3 and 1 are connected by means of the switch then the drapery will open/close (based on if the motor direction has been changed). If pins 3 and 8 are connected then the drapery will move in the opposite direction. This connection can also be used for home automation systems. Be sure the outputs (relay) are dead with no potential for electrical current.

do-it-yourself plug

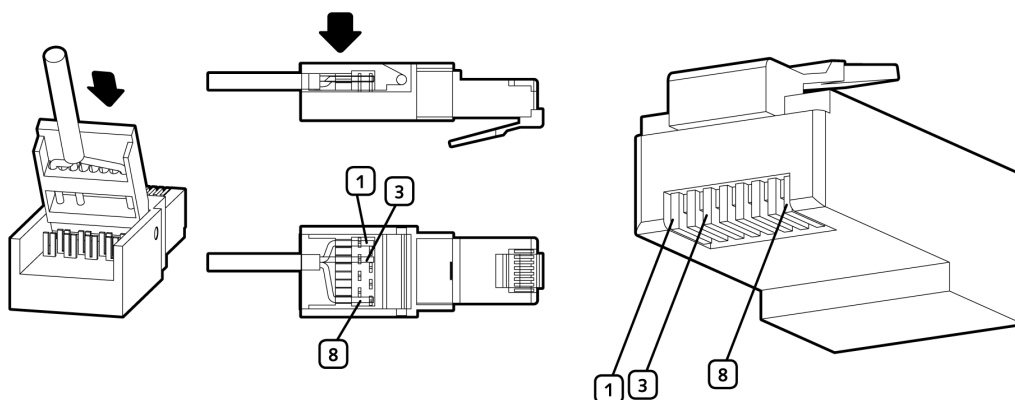

INCLUDING THE FOREST SHUTTLE INTO A Z-WAVE CONTROLLER NETWORK

Steps:

- 1) Select channel on controller by pressing the select button.
- 2) Press include/exclude button with a pin, green LED on remote will light up.
- 3) Press the button on receiver dongle, which is attached to the Forest Shuttle.
- 4) Press select button on the controller to activate the chosen channel.
- 5) Press the button on receiver dongle.
- 6) Press stop button on controller. Including is completed.

for including to several channels, repeat steps 1) thru 6)

In case of 3rd party Z-wave controller:

Follow the instructions for the Z-Wave controller into which you wish to include the Forest Shuttle to put the controller into include mode. Next press and release the Z-wave button on receiver dongle, which is attached to the Forest Shuttle. The LED on the receiver dongle will blink green once. The controller should respond with an indication that the Forest Shuttle is included successfully.

EXCLUDING THE FOREST SHUTTLE FROM A Z-WAVE NETWORK

In case of a Forest Z-wave remote:

Press and hold the include/exclude button with a pin (~6 sec.) until the red LED on the remote lights up. Press the button on the receiver dongle, which is attached to the Forest Shuttle. The green LED on the remote will blink once. Excluding the Forest Shuttle is completed.

In case of 3rd party Z-wave controller:

Follow the instructions for the Z-Wave controller from which you wish to exclude the Forest Shuttle, to put the controller into exclude mode. Then press and release the Z-wave button on receiver dongle, which is attached to the Forest Shuttle. The LED on the receiver dongle will blink green once. The controller should respond with an indication that the Forest Shuttle was excluded successfully.

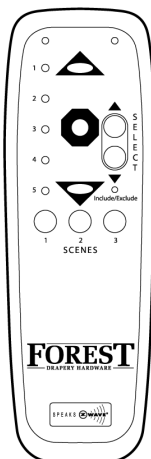

FOREST SHUTTLE INSTALL INSTRUCTIONS

BY SIMPLY FOLLOWING THESE STEP-BY-STEP INSTRUCTIONS, YOU WILL SOON BE ENJOYING YOUR NEW DRAPERY HARDWARE.

MULTIPLE CONTROLLERS IN A Z-WAVE CONTROLLER NETWORK

If you want to control one or more Forest Shuttle motors with multiple remotes, the unique address of the primary controller has to be copied to the other controller(s).

Make sure the Forest Shuttle(s) are included in the Z-wave network of the primary controller:

Press the include/exclude button of the primary controller with a pin, green LED on controller will light up. Press (on the second controller) within 10 seconds the STOP and OPEN buttons simultaneously. Red LEDs 1 to 5 on the second remote will blink fast. The unique address of the primary controller is now copied.

Now the Forest Shuttle(s) must be included to a channel of the second controller:

Select channel 1 to 5 on the second controller. Press the include/exclude button with a pin, green LED will light up. Press the select button to activate the chosen channel, red LED (1 to 5) will light up. Press the button on receiver dongle, green LED on the second controller will blink once. Press the stop button of the second controller to complete.

In case of third party Z-wave controllers:

Follow instructions for the used controller.

To reset a (second) copied controller to its original unique address:

Press and hold the select UP and DOWN buttons simultaneously for approximately 5 seconds until all 7 LEDs light up.

note

Z-WAVE INTERMEDIATE POSITIONS SETTING

Before starting these steps, first put the master carrier in the desired position.

DESCRIPTION	STEP - 1 Enter Admin Mode	STEP - 2 Select Option	STEP - 3 Confirm Option	STEP - 4 Selection
Z-Wave Intermediate Position 1	PRESS and HOLD button (~ 9 sec) until GREEN LED comes on - RELEASE button. Yellow LED blinks once.	PRESS Config button one time. Yellow LED blinks 2 times.	PRESS and HOLD button (~ 3 sec.) until GREEN LED blinks - RELEASE button.	PRESS and RELEASE button QUICKLY. GREEN LED blinks and goes out.
Z-Wave Intermediate Position 2	PRESS and HOLD button (~ 9 sec) until GREEN LED comes on - RELEASE button. Yellow LED blinks once.	PRESS Config button two times. Yellow LED blinks 3 times.	PRESS and HOLD button (~ 3 sec.) until GREEN LED blinks - RELEASE button.	PRESS and RELEASE button QUICKLY. GREEN LED blinks and goes out.

Technical specification:

Voltage: 24Vdc
Max. power: 65W
Torque: 1,8Nm
Speed: 15 cm/sec

FOREST SHUTTLE INSTALL INSTRUCTIONS

USING THE FOREST SHUTTLE WITH RF (RADIO FREQUENCY) REMOTE

TECHNICAL SPECIFICATION:

- 3V battery CR2430
- battery life > 3 years
- frequency 433.92MHz
- transmit power 10mW
- transmit range indoors: 150 feet
- working temperature -10°C - +50°C
- modes: manual, timer and dynamic timer (15 minutes + and -)
- each channel can control up to 20 receivers / motors

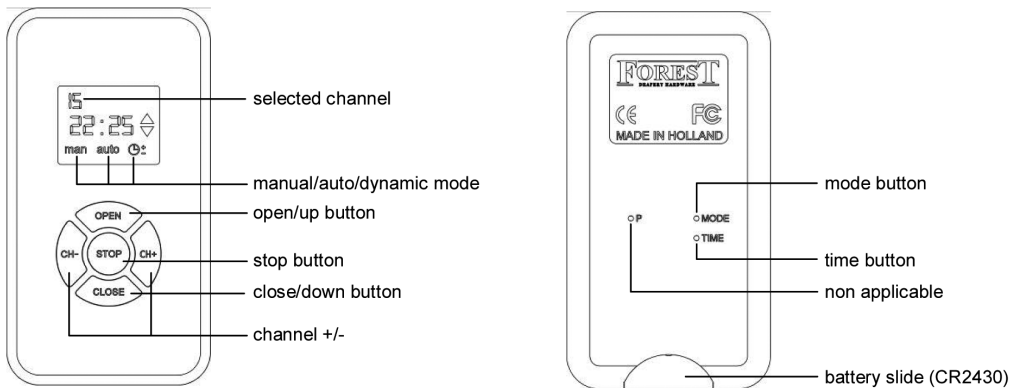

SET TIME:

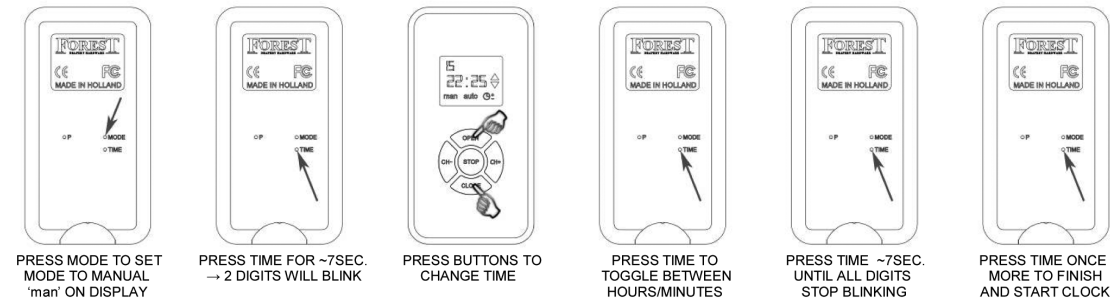

SET TIMER (EACH CHANNEL SEPARATE):

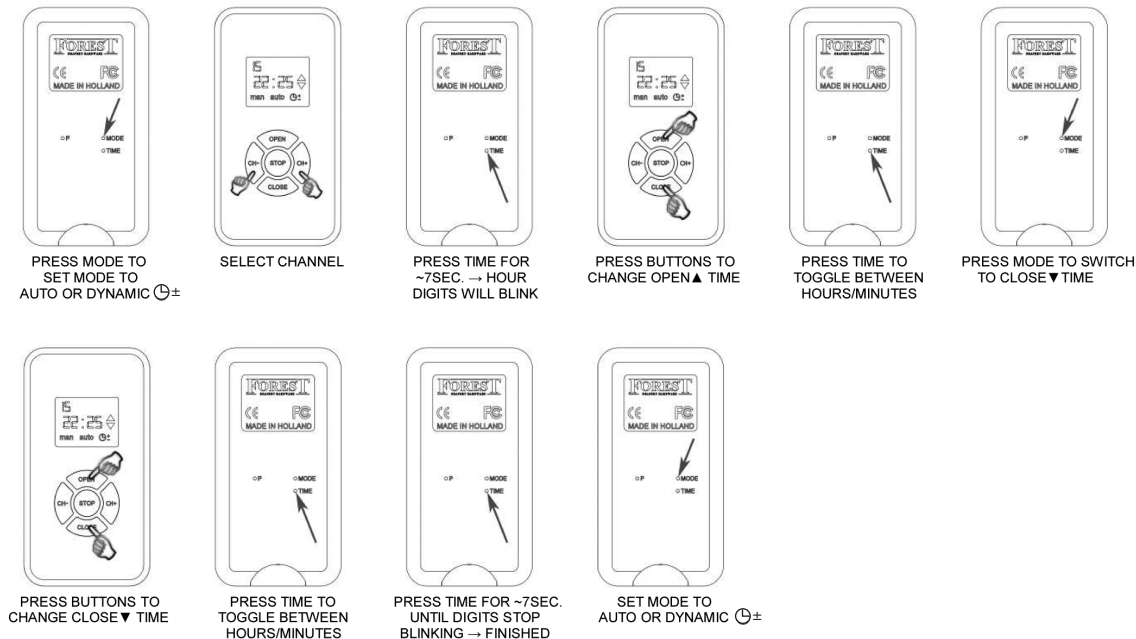

FOREST SHUTTLE INSTALL INSTRUCTIONS

USING THE FOREST SHUTTLE WITH RF (RADIO FREQUENCY) REMOTE / WALL SWITCH

TECHNICAL SPECIFICATION:

- powered by Shuttle
- can also be used as wall switch
- cable 11 feet
- works on Forest Multi Remote and Forest Multi Wall Switch RF
- connect to port 1 of the Forest Shuttle
- can control several Shuttles parallel
- working temperature -10°C - +50°C

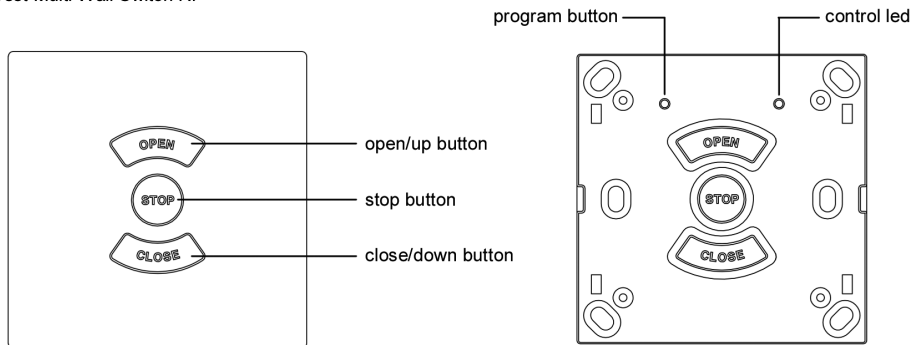

PROGRAMMING REMOTE / WALL SWITCH TO RECEIVER:

press program button LED will blink

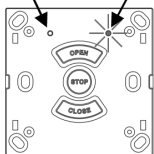

press stop button

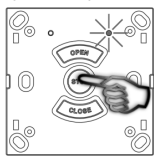

hold the remote/wall switch within 18" from receiver. Select channel and press open button:

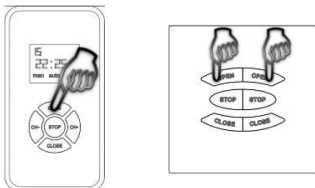

LED **must blink 3 times** and will go off

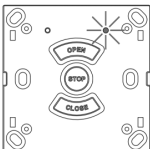

CANCEL ONE CHANNEL OF REMOTE / WALL SWITCH

press program button LED will blink

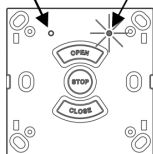

press stop button

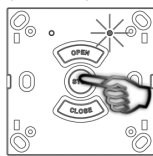

select channel and press close button:

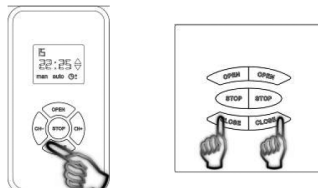

LED will blink and will go off

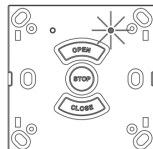

DELETE ALL PREVIOUS PROGRAMMED REMOTES / WALL SWITCHES:

press stop and close button of receiver for ~6 sec.

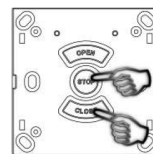

LED will blink and will go off

